

# SIMORE

## Dual-SIM Card - Instruction

### Features:

1. Two SIM Cards in one mobile phone, single standby
2. Auto-switch between SIM cards
3. Enable to edit switching time
4. Enable to edit and display name of SIM card which can be showed on phone's screen.

### Installation:

1. Place the normal SIM into the SIM slot

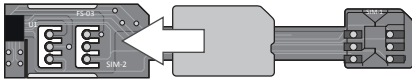

2. Place the Micro SIM on the adapter

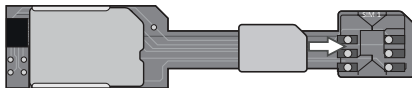

3. Turn OFF the mobile phone

4. Insert the adapter in the mobile's Micro SIM slot

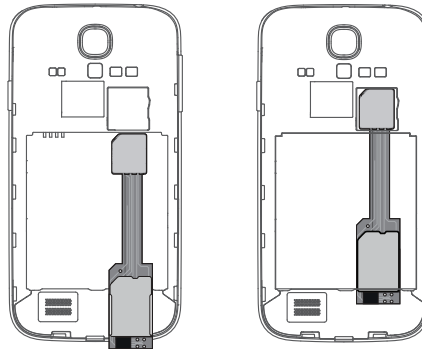

5. Power ON the mobile phone

### Instruction:

1. Enter - Applications, "SIMore" icon appears:

Switch Number  
Auto/SW  
Setup

"Switch Number" offers SIM options: "SIM1" & "SIM2" which makes SIM work individually while "Auto/SW" makes both SIM work alternately.

2. "Setup" menu provides below options:

SIM1 NO.  
SIM2 NO.  
SIM1 Time:03  
SIM2 Time:03

SIM1 NO. is to set numbers which SIM1 stands for.  
SIM2 NO. is to set numbers which SIM2 stands for.  
Default number is SIM1, another is SIM2.

Edit switching time by selecting "SIM1 TIME:03" and "SIM2 Time: 03".  
Default switch time: 3 min.  
Available switch time: 0 ~ 99 min.

### Content:

- Dual SIM Adapter × 1
- Manual × 1

### Notice:

Please restart the mobile phone if there is no signal (network) after switching.

More information on :

[WWW.SIMORE.COM](http://WWW.SIMORE.COM)