

FANTOM®

Stainless Steel Canister Vacuum Item # XDB242H for Model CV242H 10 HEPA Paper Bags

Warning: To reduce the risk of electric shock, the power cord must be disconnected before changing the HEPA bag or performing maintenance/trouble shooting checks.

Changing the HEPA Bag:

1. To open the dust bag cover, remove the flexible hose and depress the dust bag cover release button. (Fig. 1)
2. Lift dust bag cover up by handle. (Fig. 2)
3. Holding the HEPA dust bag in your hand with the arrow pointing down, slide it firmly between the slots in the bag holder. (Fig. 2)
4. Ensure that the cardboard face of bag rests securely in place. You will see the lever lock into place. (Fig. 3)
5. Replace dust bag cover. (Fig. 4)

Note: Always remove the power plug from the wall outlet before assembling or removing accessories.

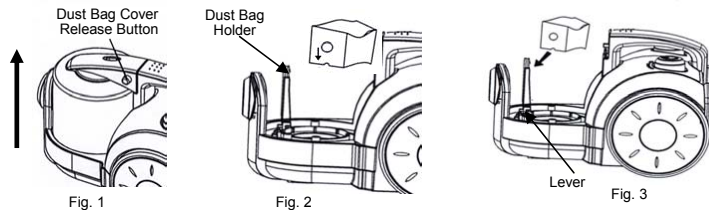

Caution: Make sure that the cardboard section of the dust bag is firmly in place inside the dust bag support.

Caution: The dust bag compartment will not close if the dust bag is not inserted properly into the unit. Never use the vacuum without a dust bag inserted into the unit. **NEVER** reuse the paper dust bags.

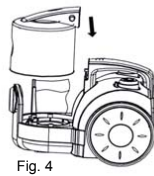

NEVER REUSE HEPA BAGS

Fantom
94 Main Mill Street, Door 16
Plattsburgh, NY 12901
Tel. :1 (800) 275-9251

Rev. 03/05
Printed in China

FANTOM®

Stainless Steel Canister Vacuum Item # XDB242H for Model CV242H 10 HEPA Paper Bags

Warning: To reduce the risk of electric shock, the power cord must be disconnected before changing the HEPA bag or performing maintenance/trouble shooting checks.

Changing the HEPA Bag:

1. To open the dust bag cover, remove the flexible hose and depress the dust bag cover release button. (Fig. 1)
2. Lift dust bag cover up by handle. (Fig. 2)
3. Holding the HEPA dust bag in your hand with the arrow pointing down, slide it firmly between the slots in the bag holder. (Fig. 2)
4. Ensure that the cardboard face of bag rests securely in place. You will see the lever lock into place. (Fig. 3)
5. Replace dust bag cover. (Fig. 4)

Note: Always remove the power plug from the wall outlet before assembling or removing accessories.

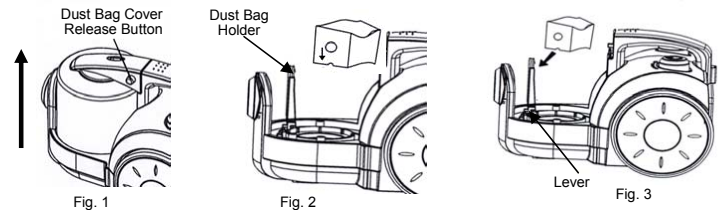

Caution: Make sure that the cardboard section of the dust bag is firmly in place inside the dust bag support.

Caution: The dust bag compartment will not close if the dust bag is not inserted properly into the unit. Never use the vacuum without a dust bag inserted into the unit. **NEVER** reuse the paper dust bags.

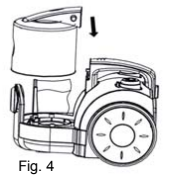

NEVER REUSE HEPA BAGS

Fantom
94 Main Mill Street, Door 16
Plattsburgh, NY 12901
Tel. :1 (800) 275-9251

Rev. 03/05
Printed in China